



DAN JOHNSON
DIRECTOR

DEPARTMENT OF TRANSPORTATION AND DEVELOPMENT

DEVELOPMENT SERVICES BUILDING

150 BEAVERCREEK ROAD OREGON CITY, OR 97045

Onsite Wastewater Existing System Verification

Site Information:

Owner: Clackamas Fire Phone: (503) 793-2600

Site Address: 18091 S. Harding Rd.
Oregon City OR 97045

Owner's mailing address same as site address

Owner's mailing address if different: _____

Email Address: _____

(TO BE COMPLETED BY CERTIFIED SEPTIC INSTALLER, MAINTENANCE PROVIDER, NAWT INSPECTOR CERTIFICATION, OR CERTIFIED SEPTIC CONSULTANT)

Date of Inspection 6/13/2024 Performed By: Paul M Fisher

Phone: (503) 656-3326 License or Certification No: RM-49

Company: Byers Septic Tank Service Inc

Email: byersseptic@gmail.com

1. Overall System Status:

- Discharge of sewage to the ground surface Yes No
- Discharge of sewage to surface waters Yes No
- Sewage backup into plumbing fixtures Yes No

2. Septic tank (s):

- Capacity 1000 gal material: Concrete

3. Dosing Tank (skip if not applicable):

- Capacity ~~_____~~ gal material: _____ mfg _____

4. Drainfield :

- Drainfield area free from roads, vehicular traffic, structures, livestock, etc: Yes No
- Drainfield area is free from surface water runoff & down spouts: Yes No
- Total number of lines 3 total lineal feet approx 300 ft
- Drainfield Distribution: Equal Serial Pressure
- Drain line(s) construction materials: Gravel Gravelless Tile Other _____
- Room for replacement area available: Yes No

5. Comments _____

This onsite sewage treatment system existing system verification is for verifying the location of an existing non-documented septic system. This document is not an indication of warranty, system certification, or guarantee of the septic system satisfactory performance for any length of time.

I have studied the information contained herein and find that my assessment is honest, thorough, and to the best of my ability, correct.

Signature: 

Date: 06 / 13 / 2024

Clackamas County Disclaimer:

Clackamas County Septic and Onsite Wastewater Systems Division assumes no responsibility for the accuracy of the information provided, nor does it guarantee the future condition or function of the onsite wastewater treatment system. Homeowners are responsible for correcting any problems noted on this form, and obtaining the proper permits prior to repair. If you have any questions about your septic system, or your system is not functioning properly, please contact Septic and Onsite Wastewater Systems Division for assistance.

Clackamas County has Received this verification on: Date: / / By: _____

Sketch of System:

1"
N
=50'

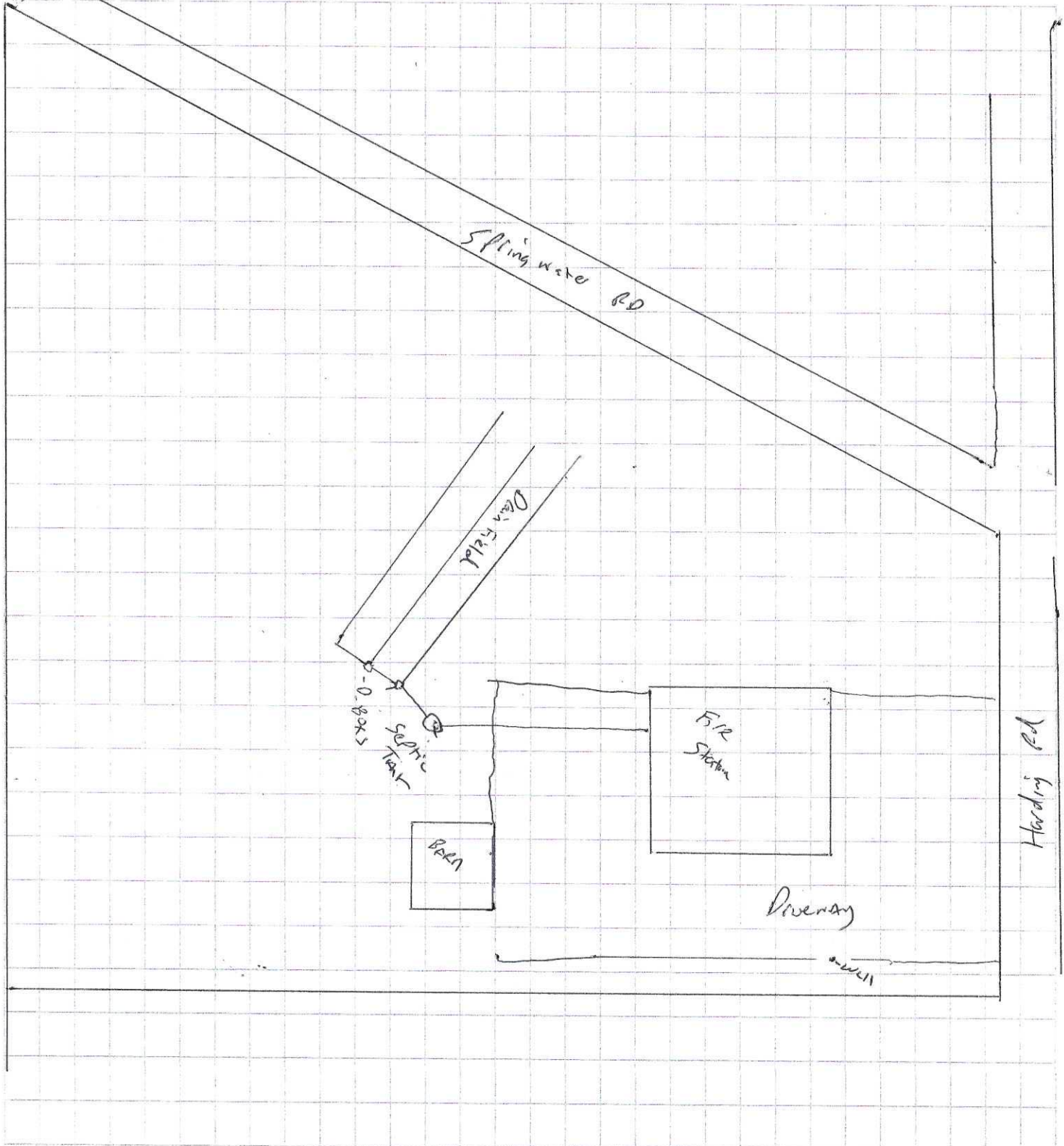

Byers Septic Tank Service
PO Box
Oregon City, OR 97045 US
byersseptic@gmail.com

Invoice

BILL TO

Clackamas County Fire District #1
11330 SE Fuller Rd.
Milwaukie, OR 97222

SHIP TO

Clackamas County Fire District #1
11330 SE Fuller Rd.
Milwaukie, OR 97222

INVOICE #	DATE	TOTAL DUE	DUE DATE	TERMS	ENCLOSED
13241	06/19/2024	\$475.00	06/19/2024	Due on receipt	

SERVICE	DESCRIPTION	QTY	RATE	AMOUNT
ESR Log	18081 S. Harding Rd.	1	475.00	475.00

BALANCE DUE

\$475.00